

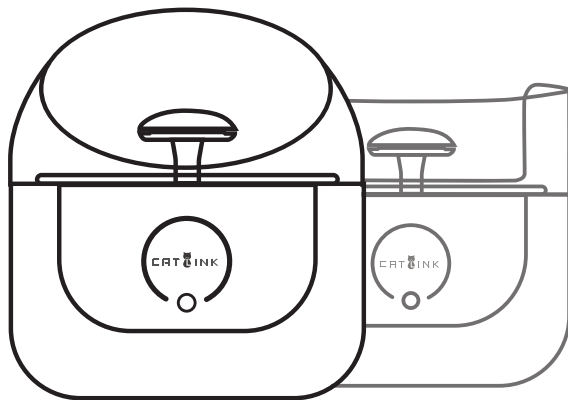

CATLINK AI Water Fountain - Pure User Manual



*Please read this manual carefully before using the product and keep this manual properly for future use.

*In order to provide better products, we will be improving our products on a regular basis. Therefore, the product picture might be slightly different than the actual product. Please refer to the actual product if so.

v1.6-20210601



User Manual

Table of Contents

Product Components List & Structure Diagram	01
Operating Modes	02
Button Instructions	03
LED Light Indicators	04
Unpacking & Filter Use Instructions	05
Network Configuration	06
Backup Power Supply & Collar and Tag Use Instructions	07
Equipment Cleaning and Precautions	08
Product Specifications	10
Customer Service	11
Warranty Service Form	12

Product Components List & Structure Diagram

Product Components



CATLINK
Collarx2



CATLINK
Tagx3



Water Fountain
Cover



Water Fountain
Column



Ceramic Tray



Water Fountain
Filter



Bucket
(includes water
pump)



Power Supply Base
(includes power
bank compartment)



Power Adapter



User Manual
(Warranty Card)

Product Structure

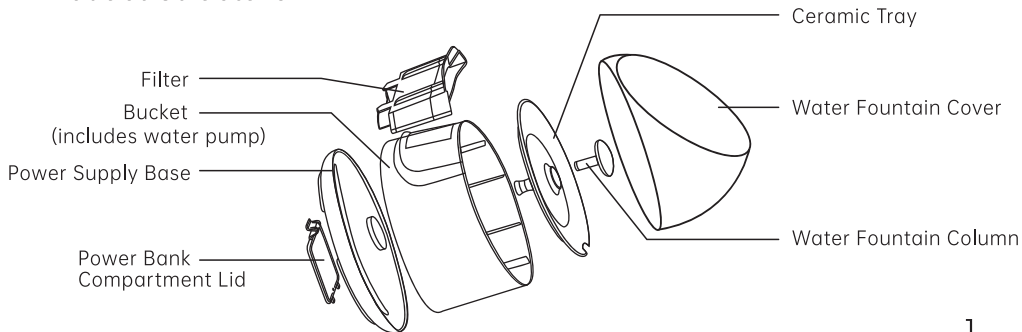

Operating Modes

Mode	What it means
Flowing Mode	The water fountain gushes non-stop and flushes hair and dirt once every few minutes.
Eco Mode	The water fountain will rest for 5 minutes after 3 minutes' flowing. Also, it will flush hair and dirt once every few minutes.
Smart Mode	When the water fountain detects cat(s), it will be automatically turned into flowing fountain mode; After the cat leaves, it will automatically flush hair and dirt, and then be turned into eco mode.

Button Instructions



Operations	Description
Press once	When the button is unlocked, press it once to switch the mode
Press three times	When the button is unlocked, press three times (LED light indicator shows WiFi is connected); when the button is locked, press three times to unlock
Long-press the button until you hear a beep sound	When button is unlocked, the water fountain will enter the network configuration mode. Pair the device with your phone to finish network configuration.

*If there is no operation within 30 seconds, the button will be automatically locked. Press three times to unlock the button.

LED Light Indicator Status

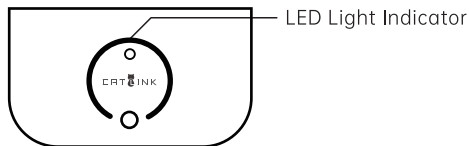

LED Light Indicator	Status
Flowing Mode	Non-stop Fountain Mode
Eco Mode (recommended)	Geyser Mode (recommended)
Smart Mode	Smart Fountain Mode
Flashing in an arch shape	Hair being flushed
Flashing green light	Waiting for network configuration
Solid green light	Connected to WiFi
Solid yellow light	Not connected to WiFi
Flashing red light	Water level is too low
Height of LED lights	Indicates the water level

Unpacking instructions

1. Check whether the items are complete according to the product components list.
2. Assemble the product properly according to the product structure diagram.
3. Make sure to use the power adapter that comes with the product; The feeder will be automatically turned on when power is on.
4. Refer to the network configuration instructions to connect the fountain to your WiFi and pair the fountain with your cell phone on the Catlink App.
5. Add enough water into the bucket, below the Max line.
6. After completing the steps above, the water fountain can be used functionally.

Filter Use Instructions

*The following steps may cause some activated carbon powder to leak out, which is normal.

*It is recommended to replace the filter every 1-2 months.

1. Unpack the filter and fully soak the filter for 1 minute in order to fully stimulate it.



2. Rinse the filter under proper water flow for 3-5 minutes with the water inlet upwards.



Network Configuration Instructions



1. Search for Catlink in your mobile application store, download and install the Catlink App, or scan the QR code on the right to download.
2. Connect your mobile phone to 2.4GHz WiFi (Currently, the fountain doesn't support 5GHz Wi-Fi or WiFi that requires special certification such as hotels and airports Wi-Fi.
*Please note that the WiFi name cannot contain Chinese, spaces, or other special characters, so as not to affect the network configuration
3. Please open Catlink App to register and log in. Then click "add equipment", choose "Catlink Fountain", and follow the instructions to finish the rest of the setup.
*Please authorize location information on your phone. (GPS needs to be turned on for Android phones.)
4. Long-press the touch button on the water fountain until you hear a beep sound and the LED light indicator starts flashing in green, then release the button.
*Please keep the water fountain as close as possible to the router and make sure that the water fountain is powered on.

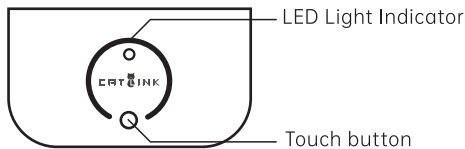

5. Finish the rest of the network configuration setup according to the instructions on Catlink App.
*There may be network configuration problems for some Android phones. If possible, you can use another phone for network configuration. After success, share the device with your own phone.
*Please contact our customer service staff for assistance in time if you have followed the network configuration instructions correctly yet still failed at configuring multiple times.
6. After completing the steps above, all the functions related to the water fountain can be used on the Catlink App.

Backup Power Instructions

1. Open the backup power compartment at the bottom of the water fountain.
2. Connect a power bank with a suitable size to the USB port of the water fountain, put it in the compartment, and close the compartment.
**It is recommended to choose a power bank with a suitable size and the capacity of 10000 mA or more to ensure the backup power supply*
3. When the main power supply is cut off, it will automatically switch to the backup power supply.

Pet Collar and Tag Use Instructions

1. Put both the collar and the tag onto your pet.
2. The tag contains an identification chip.
3. The tag is waterproof.
4. Please use the collar and the tag according to the reminders on the Catlink App.

Cleaning and Precautions

*It is recommended to clean the water fountain every half a month

1. Shut down the water fountain
(both main power and backup power if in use)



2. Separate the water fountain body
and the power supply base



3. Remove the
water fountain cover



4. Remove the ceramic tray
and the water fountain column



5. Remove the filter
(it is recommended to
replace the filter every
3-4 months)

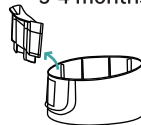

6. Parts that can be washed directly:

*Wipe the parts with dry paper towels after washing

Water Fountain Cover



Ceramic tray



Water Fountain Column



Filter



7. Parts can only be cleaned with wet wipes

(contains electronic parts and cannot be washed directly with water):

Power Supply Base



Water Fountain Body

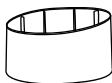

Product Specifications

Product name: Catlink PURE Ceramic Smart Water Fountain	
Product Model	CL-W-01
Package Dimensions	275x275x330 (h) mm
Product Dimensions	230x236x262 (h) mm
Product Material	ABS
Product Weight	≈1.88kg
Bucket Capacity	≈2.37L
Backup Power Compartment Dimensions	146x102x15 (h) mm
Power Input	TYPE-C 5V $\overline{=}$ 2A

*There may be differences in product specifications for different product models or batches.

Customer Service

According to relevant national regulations, we will provide customers with a one-year free warranty service.

Customer Service WeChat Accounts: 18121365823、18121136180

Customer Service Phone Number: 18117545826、18121136180

Customer Service E-mail: customer@catlinks.cn

Warranty Form

Dear Catlink user, thank you for choosing Catlink series products. Please read the following warranty clauses carefully before using this product.

1. The warranty period of this product is within one year from the date shown on your valid purchase certificate.
2. During the one-year warranty period, Shanghai Lianchong Intelligent Technology Co., Ltd. will provide free repair service for any malfunctions caused by product quality issues.
3. The following conditions are not covered by the warranty service:
 - (1) Incorrect installation, wrongful use, malicious destruction;
 - (2) Unauthorized disassembly and repair;
 - (3) Malfunction caused by the use of any third-party accessories;
 - (4) Terrible use condition;
 - (5) Exceeding the promised warranty period;
 - (6) Unable to provide any valid proof of purchase;
 - (7) Malfunction due to force majeure factors;
4. Communicate with our customer service staff in time to confirm whether your free warranty service is still valid
5. When returning the feeder, please fill out the form on the next page and attach it with the feeder.

Product Name	CATLINK PURE Ceramic Smart Water Fountain
User Name	
User Phone Number	
User Address	
Purchase date	
Purchase Channel	
Problem Description	

LINK EVERYTHING FOR CAT'S LIFE



Shanghai Lianchong Intelligent Technology Co., Ltd.
Shanghai CatLink Intelligence Co., Ltd

Official Website: WWW.CATLINK.CN

Phone Number: 0086-021-50686520

Address: 2nd Floor, Kehai Building, 800 Naxian Road, Pudong New Area, Shanghai

Manufacturer: Zhejiang Runxin Electric Co., Ltd.

CE Maintenance

- 1.Risk of explosion if battery is replaced by an incorrect type. Dispose of used batteries according to the instructions.
- 2.The product shall only be connected to a USB interface of version USB2.0.
- 3.Adapter shall be installed near the equipment and shall be easily accessible.
- 4.EUT Operating temperature range: -40° C to 85° C .
- 5.The device complies with RF specifications when the device used at 5mm from your body.

Declaration of Conformity

IMG Communication Technology Co.,Ltd hereby declares that this Mobile Phone is in compliance with the essential requirements and other relevant provisions of Directive 2014/53/EU.

This product is allowed to be used in some of EU member states. For example the following Member States can be used.

FCC Warning

This device complies with part 15 of the FCC Rules. Operation is subject to the following two conditions: (1) This device may not cause harmful interference, and (2) this device must accept any interference received, including interference that may cause undesired operation.

Any Changes or modifications not expressly approved by the party responsible for compliance could void the user's authority to operate the equipment.

Note: This equipment has been tested and found to comply with the limits for a Class B digital device, pursuant to part 15 of the FCC Rules. These limits are designed to provide reasonable protection against harmful interference in a residential installation. This equipment generates uses and can radiate radio frequency energy and, if not installed and used in accordance with the instructions, may cause harmful interference to radio communications. However, there is no guarantee that interference will not occur in a particular installation. If this equipment does cause harmful interference to radio or television reception, which can be determined by turning the equipment off and on, the user is encouraged to try to correct the interference by one or more of the following measures:

- Reorient or relocate the receiving antenna.
- Increase the separation between the equipment and receiver.
- Connect the equipment into an outlet on a circuit different from that to which the receiver is connected.
- Consult the dealer or an experienced radio/TV technician for help.

This equipment complies with FCC radiation exposure limits set forth for an uncontrolled environment. This equipment should be installed and operated with minimum distance 20cm between the radiator & your body.